

10-10 PB LB

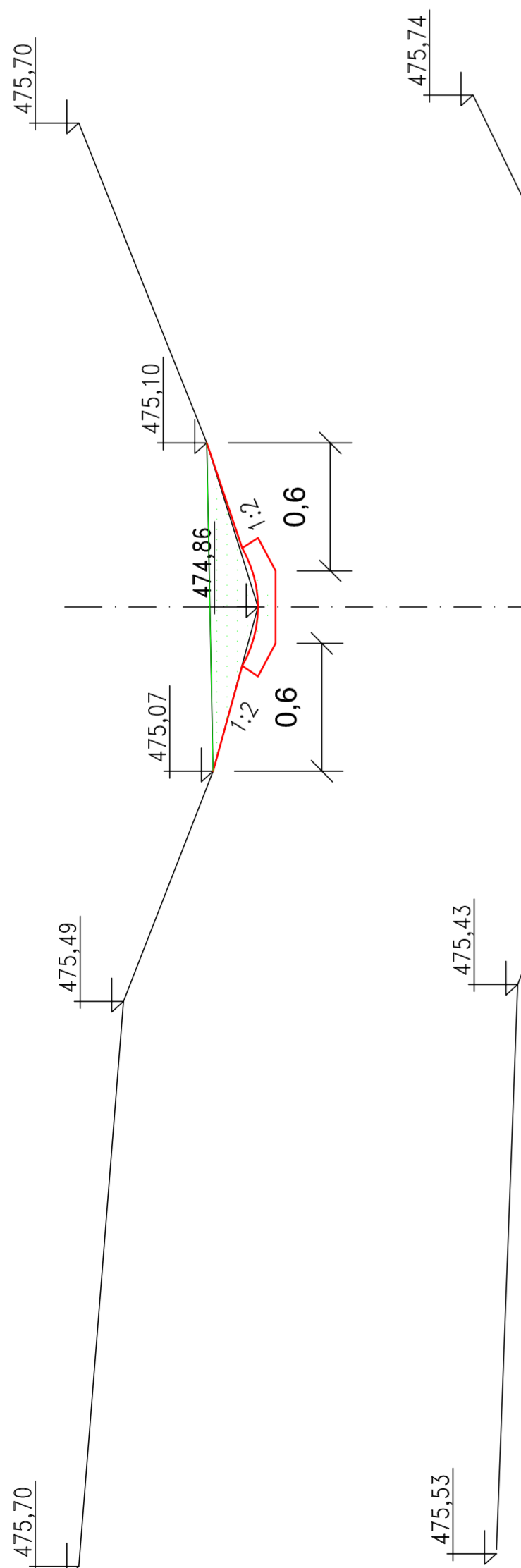

9-9

8-8

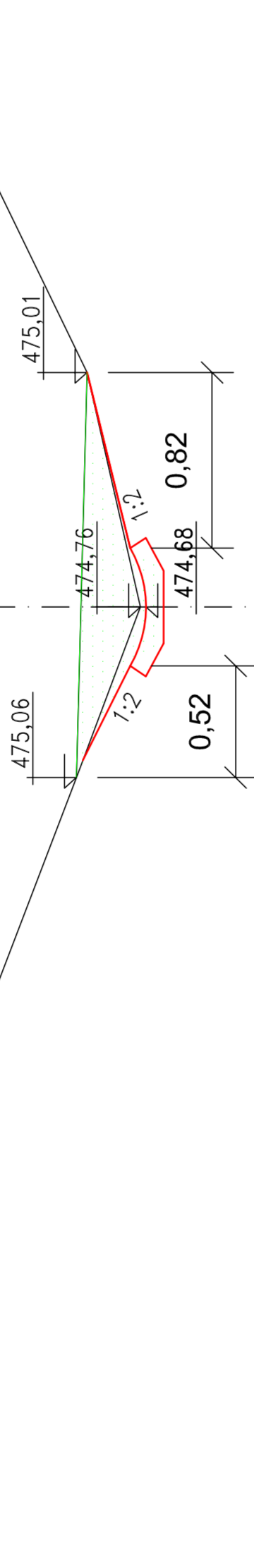

7-7

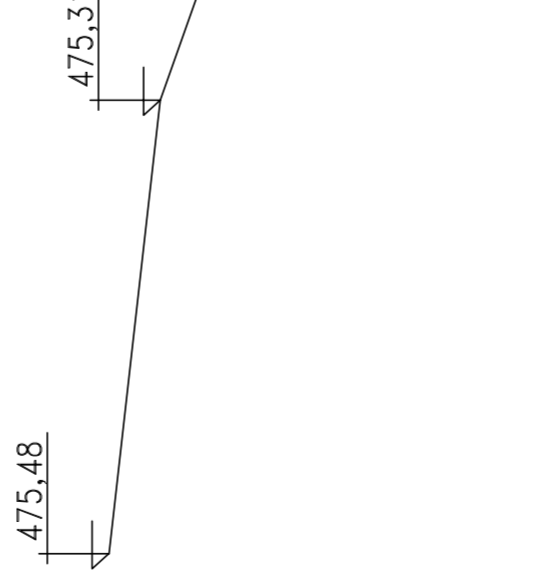

6-6

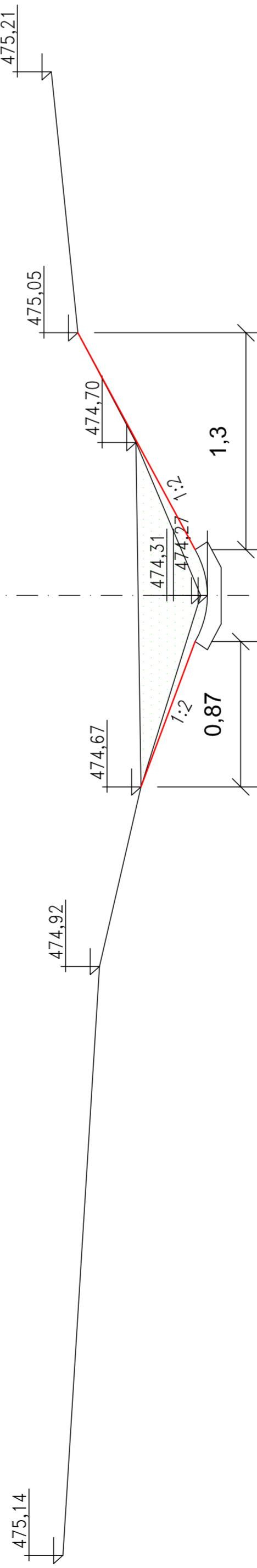

5-5'

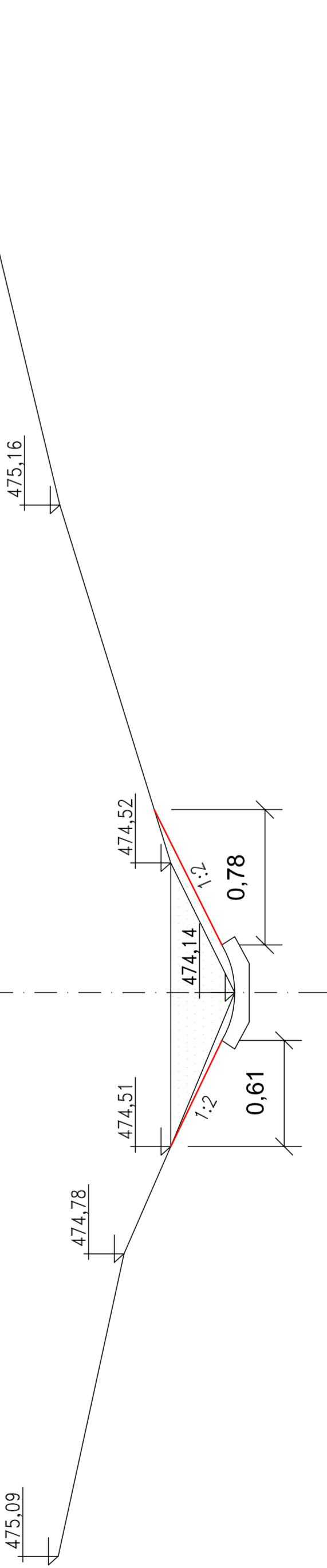

PB

LB

4-4'

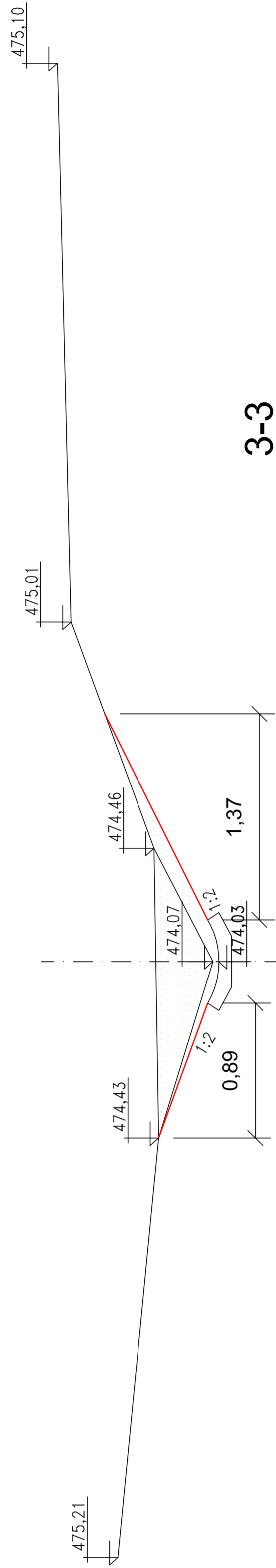

3-3

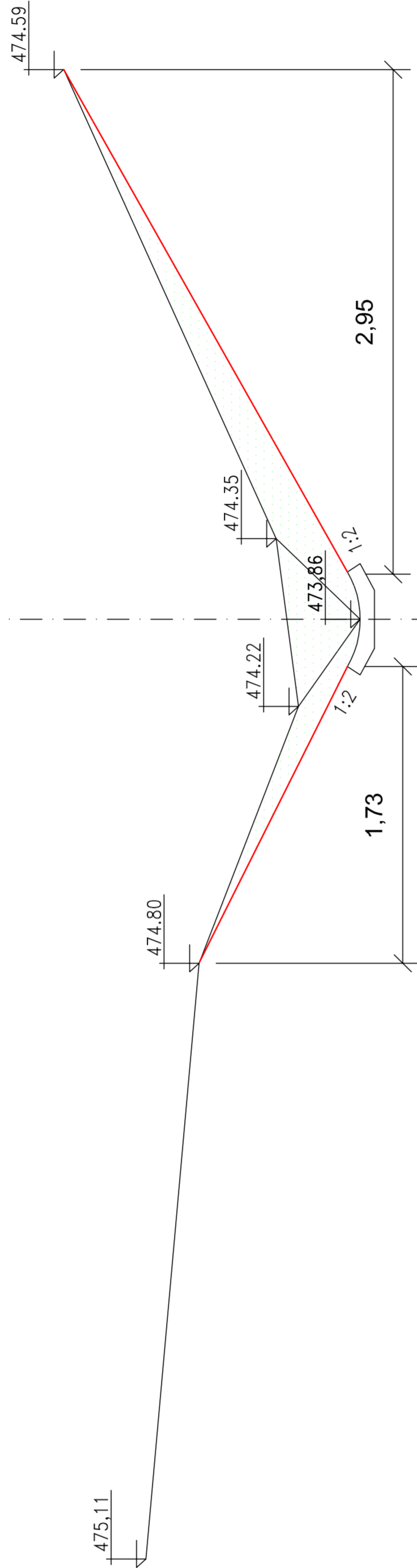

2-2'

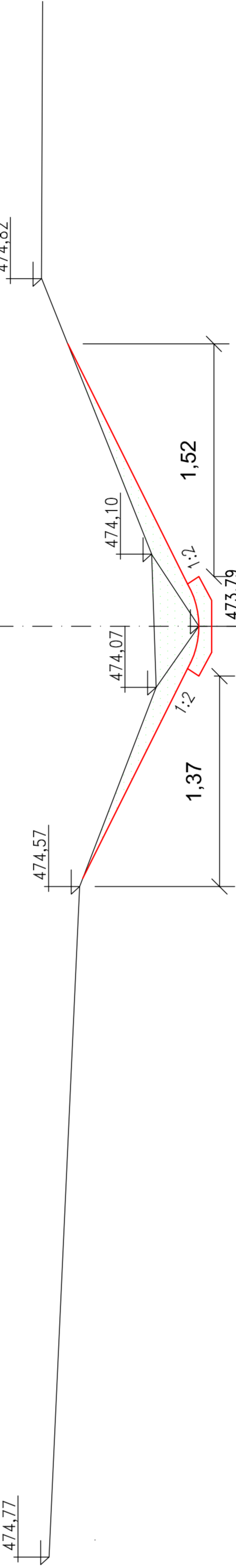

1-1'

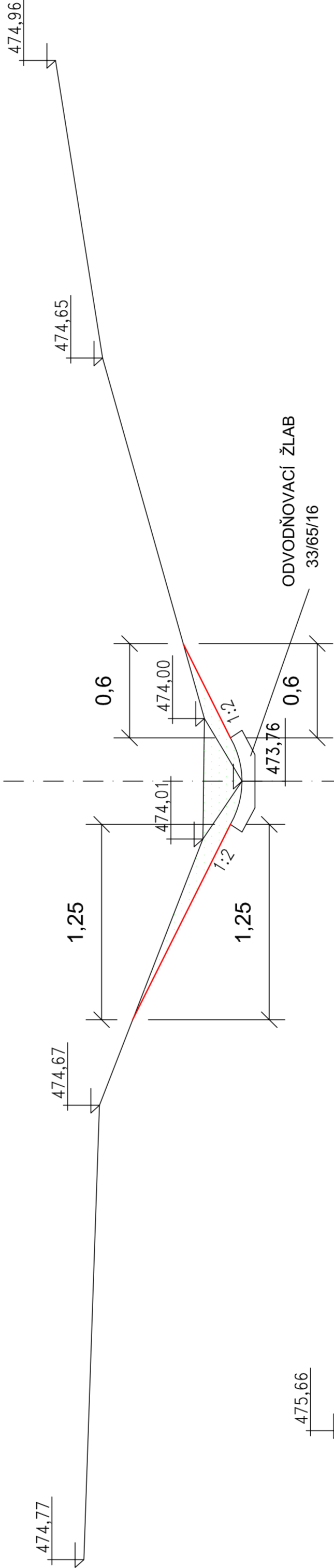

0-0

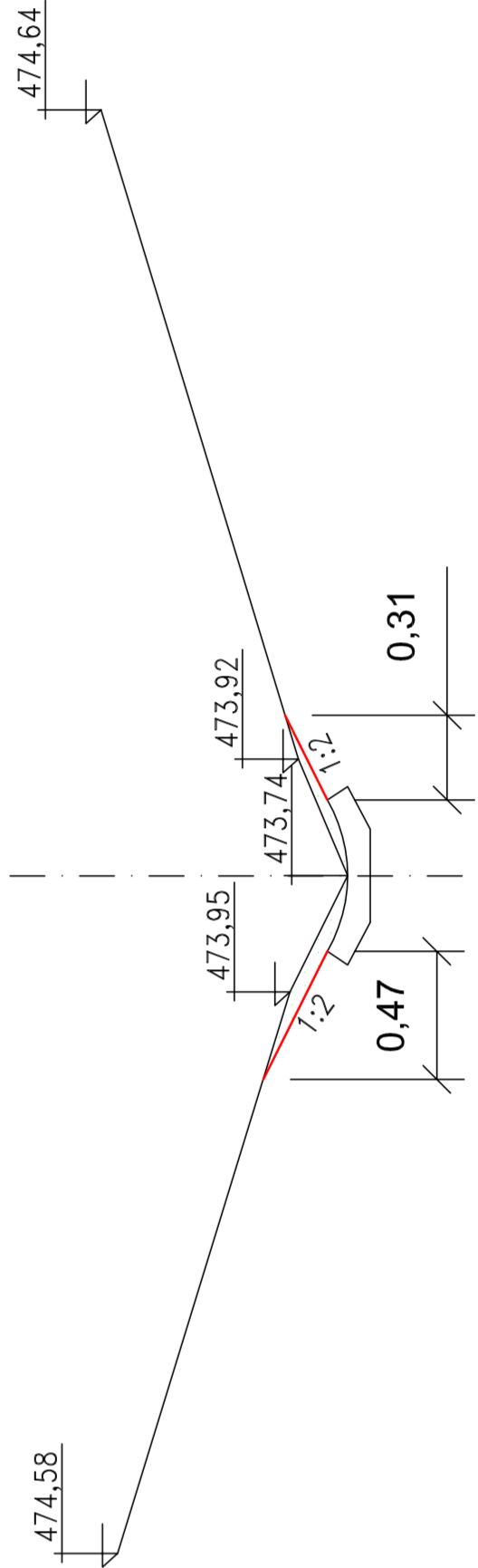

ODSTRANĚNÉ NÁNOSY

TABULKA KUBATUR

	stančení	objem	kubatura
0-0	0M 0.0	0	0
1-1	1M 5.0	5	0.4
2-2	2M 10.1	10.1	0.3
3-3	3M 30.9	30.9	0.6
4-4	4M 49.1	49.1	1
5-5	5M 72.6	72.6	0.8
6-6	6M 87.3	87.3	0.5
7-7	7M 107.5	107.5	0.5
8-8	8M 121.3	121.3	0.65
9-9	9M 143.0	143	0.7
10-10	10M 153.0	153	0.45
mostek	11M 160.0	160	0.3
konec mostku	12M 163.5	163.5	0.8
	13M 172.0	172	6.8
			103.3725

5-7SK Bv.

ZODPOVĚDNÝ PROJEKTANT: HELENA CHADIMOVÁ

VYPRACOVAL: HELENA CHADIMOVÁ

INVESTOR: POKYD LUBE SML POKR. PANECE PRÁLOVÉ

PROJEKTANT: 5-7SK Bv.

PROJEKT: 10166909

PROJEKT: 10166909

PROJEKT: 10166909

AKCE: IDVT 10166909, HAJNICE,

ODSTRANĚNÍ NÁNOSŮ Z UPRÁVENÉHO

KORYTA, ř.km. 0,090 - 0,260

Objekt: D VÝKRESY

STUPEŇ: DSP PS

DATUM: 02/2016

VERZÍ: 1:25

Č. PANE: C. PARE:

D.3

REZY